

\* required information

**Section 1 of 19**

You can save the form at any time and resume it later. You do not need to be logged in when you resume.

System reference

Not Currently In Use

This is the unique reference for this application generated by the system.

Your reference

SM/6232

You can put what you want here to help you track applications if you make lots of them. It is passed to the authority.

Are you an agent acting on behalf of the applicant?

Yes

No

Put "no" if you are applying on your own behalf or on behalf of a business you own or work for.

**Applicant Details**

\* First name

Steve

\* Family name

Mahoney

\* E-mail

smahoney

Main telephone number

01277 376357

Include country code.

Other telephone number

Indicate here if you would prefer not to be contacted by telephone

Are you:

Applying as a business or organisation, including as a sole trader

Applying as an individual

A sole trader is a business owned by one person without any special legal structure. Applying as an individual means you are applying so you can be employed, or for some other personal reason, such as following a hobby.

**Applicant Business**

\* Is your business registered in the UK with Companies House?

Yes

No

\* Registration number

298945

\* Business name

McColls Retail Group

If your business is registered, use its registered name.

\* VAT number

GB

246277839

Put "none" if you are not registered for VAT.

\* Legal status

Private Limited Company

Continued from previous page...

\* Your position in the business

Home country

The country where the headquarters of your business is located.

**Registered Address**

Address registered with Companies House.

\* Building number or name

\* Street

District

\* City or town

County or administrative area

\* Postcode

\* Country

**Section 2 of 19**

**PREMISES DETAILS**

I/we, as named in section 1, apply for a premises licence under section 17 of the Licensing Act 2003 for the premises described in section 2 below (the premises) and I/we are making this application to you as the relevant licensing authority in accordance with section 12 of the Licensing Act 2003.

**Premises Address**

Are you able to provide a postal address, OS map reference or description of the premises?

Address     OS map reference     Description

**Postal Address Of Premises**

Building number or name

Street

District

City or town

County or administrative area

Postcode

Country

**Further Details**

Telephone number

Non-domestic rateable value of premises (£)

**Section 3 of 19**

**APPLICATION DETAILS**

In what capacity are you applying for the premises licence?

- An individual or individuals
- A limited company
- A partnership
- An unincorporated association
- A recognised club
- A charity
- The proprietor of an educational establishment
- A health service body
- A person who is registered under part 2 of the Care Standards Act 2000 (c14) in respect of an independent hospital in Wales
- A person who is registered under Chapter 2 of Part 1 of the Health and Social Care Act 2008 in respect of the carrying on of a regulated activity (within the meaning of that Part) in an independent hospital in England
- The chief officer of police of a police force in England and Wales
- Other (for example a statutory corporation)

**Confirm The Following**

- I am carrying on or proposing to carry on a business which involves the use of the premises for licensable activities
- I am making the application pursuant to a statutory function
- I am making the application pursuant to a function discharged by virtue of Her Majesty's prerogative

**Section 4 of 19**

**NON INDIVIDUAL APPLICANTS**

Provide name and registered address of applicant in full. Where appropriate give any registered number. In the case of a partnership or other joint venture (other than a body corporate), give the name and address of each party concerned.

**Non Individual Applicant's Name**

Name

**Details**

Registered number (where applicable)

Description of applicant (for example partnership, company, unincorporated association etc)

Continued from previous page...

Public Limited Company

**Address**

Building number or name   
Street   
District   
City or town   
County or administrative area   
Postcode   
Country

**Contact Details**

E-mail   
Telephone number   
Other telephone number

**Section 5 of 19**

**OPERATING SCHEDULE**

When do you want the premises licence to start?  /  /   
dd mm yyyy

If you wish the licence to be valid only for a limited period, when do you want it to end  /  /   
dd mm yyyy

Provide a general description of the premises

For example the type of premises, its general situation and layout and any other information which could be relevant to the licensing objectives. Where your application includes off-supplies of alcohol and you intend to provide a place for consumption of these off-supplies you must include a description of where the place will be and its proximity to the premises.

The premises are a brick built construction and presently trade as a convenience store but without the benefit of a Premises Licence. Included with this application is a layout plan which confirms that the whole of the retail sales floor area is proposed to be covered by this application. Alcohol will be displayed within the retail area in such positions where it can be supervised by a combination of direct staff supervision and/or CCTV. The CCTV system will form part of the due diligence system which will be operable at the store (images will be maintained for a minimum of 31 days) The due diligence systems will also incorporate the operation of a refusals record together with general staff training providing guidance upon both the legal and social aspects of selling alcohol. The Company also provide continual external support through test purchasing operations. The Licensable activities will take place between the hours as specified on page 17 of this application form. This is an overview of the type of premises.

*Continued from previous page...*

If 5,000 or more people are expected to attend the premises at any one time, state the number expected to attend

**Section 6 of 19**

**PROVISION OF PLAYS**

Will you be providing plays?

Yes

No

**Section 7 of 19**

**PROVISION OF FILMS**

Will you be providing films?

Yes

No

**Section 8 of 19**

**PROVISION OF INDOOR SPORTING EVENTS**

Will you be providing indoor sporting events?

Yes

No

**Section 9 of 19**

**PROVISION OF BOXING OR WRESTLING ENTERTAINMENTS**

Will you be providing boxing or wrestling entertainments?

Yes

No

**Section 10 of 19**

**PROVISION OF LIVE MUSIC**

Will you be providing live music?

Yes

No

**Section 11 of 19**

**PROVISION OF RECORDED MUSIC**

Will you be providing recorded music?

Yes

No

**Section 12 of 19**

**PROVISION OF PERFORMANCES OF DANCE**

Will you be providing performances of dance?

Yes

No

**Section 13 of 19**

**PROVISION OF ANYTHING OF A SIMILAR DESCRIPTION TO LIVE MUSIC, RECORDED MUSIC OR PERFORMANCES OF DANCE**

Will you be providing anything similar to live music, recorded music or performances of dance?

Yes

No

Continued from previous page...

**Section 14 of 19**

**LATE NIGHT REFRESHMENT**

Will you be providing late night refreshment?

Yes

No

**Section 15 of 19**

**SUPPLY OF ALCOHOL**

Will you be selling or supplying alcohol?

Yes

No

**Standard Days And Timings**

MONDAY

Start

End

Start

End

TUESDAY

Start

End

Start

End

WEDNESDAY

Start

End

Start

End

THURSDAY

Start

End

Start

End

FRIDAY

Start

End

Start

End

SATURDAY

Start

End

Start

End

SUNDAY

Start

End

Start

End

Give timings in 24 hour clock.  
(e.g., 16:00) and only give details for the days  
of the week when you intend the premises  
to be used for the activity.

Continued from previous page...

Will the sale of alcohol be for consumption:

On the premises     Off the premises     Both

If the sale of alcohol is for consumption on the premises select on, if the sale of alcohol is for consumption away from the premises select off. If the sale of alcohol is for consumption on the premises and away from the premises select both.

State any seasonal variations

For example (but not exclusively) where the activity will occur on additional days during the summer months.

Non-standard timings. Where the premises will be used for the supply of alcohol at different times from those listed in the column on the left, list below

For example (but not exclusively), where you wish the activity to go on longer on a particular day e.g. Christmas Eve.

State the name and details of the individual whom you wish to specify on the licence as premises supervisor

**Name**

First name

Family name

**Enter the contact's address**

Building number or name

Street

District

City or town

County or administrative area

Postcode

Country

Personal Licence number (if known)

Issuing licensing authority (if known)

Continued from previous page...

### PROPOSED DESIGNATED PREMISES SUPERVISOR CONSENT

How will the consent form of the proposed designated premises supervisor be supplied to the authority?

- Electronically, by the proposed designated premises supervisor
- As an attachment to this application

Reference number for consent form (if known)

If the consent form is already submitted, ask the proposed designated premises supervisor for its 'system reference' or 'your reference'.

### Section 16 of 19

#### ADULT ENTERTAINMENT

Highlight any adult entertainment or services, activities, or other entertainment or matters ancillary to the use of the premises that may give rise to concern in respect of children

Give information about anything intended to occur at the premises or ancillary to the use of the premises which may give rise to concern in respect of children, regardless of whether you intend children to have access to the premises, for example (but not exclusively) nudity or semi-nudity, films for restricted age groups etc gambling machines etc.

These premises will benefit from a Premises Licence for consumption of alcohol off the premises only. there will be no adult entertainment in order to ensure compliance with legislation. The company will operate a 'Challenge 25' policy as a minimum requirement whereby any person appearing to be aged 25 or under must prove that they are in fact over the lawful age of 18 for the purpose of sale of alcohol. Acceptable forms of identification as proof of age are a ten year passport, a photocard driving licence and an approved PASS logo proof of age card. All staff are obligated to familiarise themselves with these requirements. The company will operate a due diligence policy, incorporating the minimum challenge 25 policy as above, also incorporating full training for all staff, the operation of a refusal record and refresher training on a regular basis.

This store will operate a fully recordable CCTV system which is overtly operable. There will be a prominent signage located throughout the store confirming the legal minimum age for the purchase of alcohol and the company policy.

### Section 17 of 19

#### HOURS PREMISES ARE OPEN TO THE PUBLIC

##### Standard Days And Timings

###### MONDAY

Start

End

Start

End

Give timings in 24 hour clock. (e.g., 16:00) and only give details for the days of the week when you intend the premises to be used for the activity.

###### TUESDAY

Start

End

Start

End

###### WEDNESDAY

Start

End

Start

End



Continued from previous page...

THURSDAY

Start	<input type="text" value="06:00"/>	End	<input type="text" value="23:00"/>
Start	<input type="text"/>	End	<input type="text"/>

FRIDAY

Start	<input type="text" value="06:00"/>	End	<input type="text" value="23:00"/>
Start	<input type="text"/>	End	<input type="text"/>

SATURDAY

Start	<input type="text" value="06:00"/>	End	<input type="text" value="23:00"/>
Start	<input type="text"/>	End	<input type="text"/>

SUNDAY

Start	<input type="text" value="06:00"/>	End	<input type="text" value="23:00"/>
Start	<input type="text"/>	End	<input type="text"/>

State any seasonal variations

For example (but not exclusively) where the activity will occur on additional days during the summer months.

Non standard timings. Where you intend to use the premises to be open to the members and guests at different times from those listed in the column on the left, list below

For example (but not exclusively), where you wish the activity to go on longer on a particular day e.g. Christmas Eve.

**Section 18 of 19**

**LICENSING OBJECTIVES**

Describe the steps you intend to take to promote the four licensing objectives:

a) General – all four licensing objectives (b,c,d,e)

List here steps you will take to promote all four licensing objectives together.

We are a national retailer that sells alcohol as part of a broad offering of goods and services. We have held off-licenses in our stores for many years and are an approved British Institute of Inn-Keeping examination centre. We have written training policies and formal training programs are in place, which ensure our people are equipped to meet all licensing objectives. All training and revision / refresher materials are reviewed regularly. We have introduced our "Think 25" policy to all our stores, this policy is brought to the customers attention through point of sale material at the checkout and wherever alcohol is displayed for sale.

b) The prevention of crime and disorder

*Continued from previous page...*

The premises has digital CCTV system that covers many areas of the shop floor, including the proposed area which will be used for display of beer and wine. High value alcoholic products such as champagne and spirits will be displayed behind the sales counter.

Images are retained for a minimum of 31 days and made available on request by an authorised person.

A member of the Management team is on the premises all the time the store is open

c) Public safety

A member of the Management team is on the premises all the time the store is open and is trained to manage the store including looking after the safety of the public.

The store adheres to all rules and regulations relating to public safety.

d) The prevention of public nuisance

These premises are proposed to be licensed for the consumption of liquor off the premises only. In addition to there being no consumption on the premises, there is no form of entertainment on the premises. There are no outdoor area utilised for the benefit of member of the public and the nature of the operation does not require the employment of door supervisors or use of dedicated cab firms. The store is an active member of the community and is always happy to liaise with police and enforcement authorities should the need arise

e) The protection of children from harm

All staff are trained and have regular refresher training on the corporate "Think 25" policy. Staff are trained to look at the customer and "Think 25" when selling age restricted products.

A till prompt will appear on the initial sale of alcohol that will remind the seller of the Think 25 policy and remind staff not to sell alcohol to anyone under the age of 18. The Company also provide continual external support through test purchasing operations. When alcohol is refused by the seller the refusal is recorded and refusals frequently checked on a regular basis by a Manager.

The store displays signage around the store informing both staff and customers of our "Think 25" policy.

## Section 19 of 19

### PAYMENT DETAILS

This fee must be paid to the authority. If you complete the application online, you must pay it by debit or credit card.

Premises Licence Fees are determined by the non-domestic rateable value of the premises.

To find out a premises non domestic rateable value go to the Valuation Office Agency site at [http://www.voa.gov.uk/business\\_rates/index.htm](http://www.voa.gov.uk/business_rates/index.htm)

Band A - No RV to £4300 £100.00

Band B - £4301 to £33000 £190.00

Band C - £33001 to £8700 £315.00

Band D - £87001 to £12500 £450.00\*

Band E - £125001 and over £635.00\*

\*If the premises rateable value is in Bands D or E and the premises is primarily used for the consumption of alcohol on the premises then you are required to pay a higher fee

Band D - £87001 to £12500 £900.00

Band E - £125001 and over £1,905.00

There is an exemption from the payment of fees in relation to the provision of regulated entertainment at church halls, chapel halls or premises of a similar nature, village halls, parish or community halls, or other premises of a similar nature. The costs associated with these licences will be met by central Government. If, however, the licence also authorises the use of the premises for the supply of alcohol or the provision of late night refreshment, a fee will be required.

Schools and sixth form colleges are exempt from the fees associated with the authorisation of regulated entertainment where the entertainment is provided by and at the school or college and for the purposes of the school or college.

If you operate a large event you are subject to ADDITIONAL fees based upon the number in attendance at any one time  
Capacity 5000-9999 £1,000.00

**Continued from previous page...**

Capacity 10000 -14999 £2,000.00  
Capacity 15000-19999 £4,000.00  
Capacity 20000-29999 £8,000.00  
Capacity 30000-39000 £16,000.00  
Capacity 40000-49999 £24,000.00  
Capacity 50000-59999 £32,000.00  
Capacity 60000-69999 £40,000.00  
Capacity 70000-79999 £48,000.00  
Capacity 80000-89999 £56,000.00  
Capacity 90000 and over £64,000.00

\* Fee amount (£)

190.00

**DECLARATION**

\* I/we understand it is an offence, liable on conviction to a fine up to level 5 on the standard scale, under section 158 of the licensing act 2003, to make a false statement in or in connection with this application.

Ticking this box indicates you have read and understood the above declaration

This section should be completed by the applicant, unless you answered "Yes" to the question "Are you an agent acting on behalf of the applicant?"

\* Full name

\* Capacity

\* Date

 /  / 

dd mm yyyy

Add another signatory

Once you're finished you need to do the following:

1. Save this form to your computer by clicking file/save as...
2. Go back to <https://www.gov.uk/apply-for-a-licence/premises-licence/epping-forest/apply-1> to upload this file and continue with your application.

Don't forget to make sure you have all your supporting documentation to hand.

**IT IS AN OFFENCE, LIABLE ON SUMMARY CONVICTION TO A FINE NOT EXCEEDING LEVEL 5 ON THE STANDARD SCALE, UNDER SECTION 158 OF THE LICENSING ACT 2003, TO MAKE A FALSE STATEMENT IN OR IN CONNECTION WITH THIS APPLICATION**

**OFFICE USE ONLY**

Applicant reference number	<input type="text" value="SM/6232"/>
Fee paid	<input type="text"/>
Payment provider reference	<input type="text"/>
ELMS Payment Reference	<input type="text"/>
Payment status	<input type="text"/>
Payment authorisation code	<input type="text"/>
Payment authorisation date	<input type="text"/>
Date and time submitted	<input type="text"/>
Approval deadline	<input type="text"/>
Error message	<input type="text"/>
Is Digitally signed	<input type="checkbox"/>

LIC11A

## Consent of individual to be specified as premises supervisor

I, **Steve Mahoney**

of

Hereby confirm that I give my consent to be specified as the designated premises supervisor in relation to the application for a premises licence

By **Martin McColl Limited**

Relating to a Premises Licence for **Martin McColls, 3 Brook Parade, Chigwell, Essex, IG7 6PE**

And any premises licence to be granted or varied in respect of this application made by **Martin McColl Limited**

Concerning the supply of alcohol at **Martin McColls, 3 Brook Parade, Chigwell, Essex, IG7 6PE**

I also confirm that I am applying for, intend to apply or currently hold a personal licence, details of which I set out below.

Personal licence number

Personal licence issuing authority:

Name **Steve Mahoney**

DOB:

Place of Birth:

Signed

Dated **27/03/2014**



**McColl's Martin's RSM-Coil**

McCOLLS RETAIL GROUP LTD  
 ASHWELLS ROAD  
 BRENTWOOD  
 CHES 86T  
 TEL: 0207 2294  
 FAX: 0207 2294

PROJECT TYPE/DETAILS  
 ALCOHOL LICENCE APPLICATION

Rev	Revision Details
A	PROPOSED SH-560/2014

STORE NO:	REV NO	DATE	POSTING REF
6222	A	11/10/10	624
STORE NAME:	NUMBER	AREA	POST OFFICE
CHISWELL BROOK PARADE	34	34	34
ADDRESS PARADE	SOFT AREA	GENERAL AREA	POST OFFICE
CHISWELL	34	34	34
ESSEX	34	34	34
IG7 6PE	34	34	34
STORE TEL: 0208 800 2288			
COMPRO SERO DETAILS	GRID MATRIX	M/A AREA	
COMPANY: CD	6	M/A	
PROMO: CN	6	M/A	

PROMOTION DETAILS	AGREED BY:
PRIMA DATE	1
PRIMA REFERENCE	11
ALCOHOL STRACTIONS	8
CHECK DATE	N
LOTTERY DATE	Y
BUYER/BOOK	Y
REP BALL DATE	N
CLUB/CLUB	N
ALPH	TTV
PROTECTOR/DATE	N
VIDEO/POSTABLE	Y
VIDEO TONER	Y

DRAWN BY	PHILIP THOMNEY
DRAWING DATE	10/03/2014

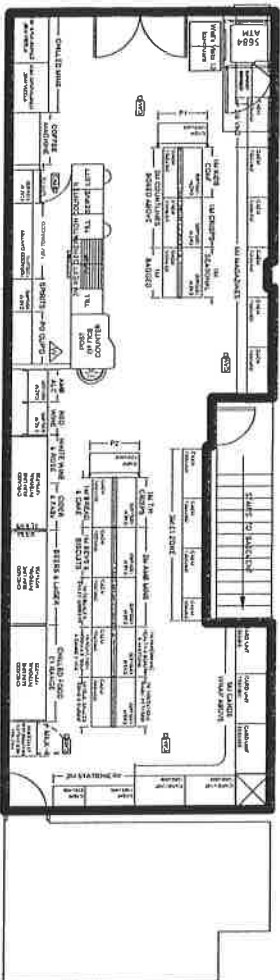

PROPOSED STORE PLAN

**FIRE SIGNAGE:**

- ☐ EMERGENCY LIGHTING
- ☐ FIRE EXIT SIGNS
- ☐ FIRE EXIT SIGN WITH DIRECTIONAL ARROW
- ☐ FIRE EXIT SIGN WITH RUNNING MAN
- ☐ FIRE EXTINGUISHER - WATER
- ☐ FIRE EXTINGUISHER - CO2
- ☐ FIRE EXTINGUISHER - FOAM
- ☐ SMOKE DETECTOR
- ☐ BREAK GLASS POINT
- ☐ FIRE ALARM PANEL
- ☐ FIRE DOOR
- ☐ FIRE ACTION SIGNAGE
- ☐ SECURITY CAMERA (FIRE EXTINGUISHER SIGNAGE TO BE PROVIDED AT EACH LOCATION)

**NOTES:**

1. FIRE FIGHTING EQUIPMENT & ALL OF THE REQUIREMENTS OF THE FIRE SERVICE WILL BE PROVIDED & WILL BE PROVIDED TO COMPLY WITH THE EUROPEAN STANDARDS
2. ALL WALL PERIMETER FIXTURES TO A HEIGHT OF 2.1M
3. ALL FLOOR DISPLAYS TO A HEIGHT OF 1.5M
4. COUNTER HEIGHT 965MM

**FIRE STANDARDS:**

1. FIRE SAFETY RELATED SIGNS AND NOTICES ARE TO THE HEALTH AND SAFETY (SAFETY SIGNS & SIGNALS) REGULATIONS ACT 1986, THOSE THAT COMPLY TO BS 5499, PART 1, 1980 ALSO COMPLY.
2. ILLUMINATED "EXIT" SIGNS ARE TO CONFORM TO BS2580
3. FIRE FIGHTING EQUIPMENT IS TO COMPLY WITH EUROPEAN STANDARDS BS EN3 AND BS 7883

Public Notices

EPHING FOREST DISTRICT COUNCIL
NOTICE OF VARIATION GIVEN UNDER SECTIONS 35C AND 46A OF THE ROAD TRAFFIC REGULATION ACT 1984 - EPHING FOREST DISTRICT COUNCIL (OFF-STREET PARKING PLACES) ORDER 2011 (AS AMENDED)

NOTICE IS HEREBY GIVEN that the Epping Forest District Council intends, not less than twenty-one days from the date of this notice, to vary the above Order relating to fees and charges at Borough car parks under Section 35C and 46A of the Road Traffic Regulation Act 1984. It is intended that the changes will take place on 05 May 2014.

The variation will have the effect of changing the tariff of fees and charges (known as the parking rate) at the following locations - at other locations will continue at their existing tariffs. Tariffs do not apply on any Bank/Public Holidays throughout the year or on any Saturdays in December, excluding Sainsbury's Car Parks.

Table with 3 columns: Car Park, Location, and Tariff. Lists various car parks like Bakern Lane, Barrows Lane, and Civic Offices with their respective locations and tariffs.

Table with 3 columns: Tariff, Previous Charge, and New Charge. Shows changes for short stay car parks (up to 30 minutes, 1 hour, 2 hours, 3 hours, over 3 hours).

Table with 3 columns: Tariff, Previous Charge, and New Charge. Shows changes for combined stay car parks (up to 30 minutes, 1 hour, 2 hours, over 2 hours).

Table with 3 columns: Tariff, Previous Charge, and New Charge. Shows changes for long stay car parks (up to 2 hours, over 2 hours).

Table with 3 columns: Tariff, Previous Charge, and New Charge. Shows changes for cotch lane short stay car parks (up to 30 minutes, 1 hour, 2 hours, up to 4 hours, up to 5 hours).

John Gilbert, Director of Environment and Street Scene, Epping Forest District Council



Notice Of Application For Planning Permissions Under Article 13 Of The Town and Country Planning (Development Management Procedure) (England) Order 2010 The Town And Country Planning Act 1990 (As Amended)

In accordance with the above act and related legislation, notice is hereby given that the application forms, plans and other documents submitted in relation to the proposed development below may be examined at the London Legacy Development Corporation reception Level 10, 1 Stratford Place, Manchester Road, London E20 1EJ.

Goods Vehicle Operator's Licence

Leslie Fireman trading as Select Sweeper Hire Ltd of 55 Halesbury Avenue, Stratford, Middlesex EN1 1JZ is applying for a licence to use a motor vehicle, and a certificate for goods vehicles and 0 trailers.

THE ESTATE OF IAN MELAN (DECEASED) NOTICE PURSUANT TO SECTION 27 OF THE INTESTATE ESTATE ACT 1925...

Notice of Application for a New Premises Licence under the Licensing Act 2003

Notice is given this day Monday 7th April that Lambourne Manor Head, Lambourne End Centre, Essex, RM4 1NH has applied to the Licensing office of Epping Forest District Council for a new premises licence for outdoor learning.

There's no substitute for experience

Guardian Established over 130 years. To advertise telephons our display team on 0844 499 3118 guardian-series.co.uk

SPECIAL TREATMENT LICENCES

NOTICE IS GIVEN that the following has applied to the Licensing Office of Epping Forest District Council for a Special Treatment Licence for the premises at 112 High Road, Leyton, London E15 3HX.

NOTICE OF APPLICATION FOR THE GRANT OF A PREMISES LICENCE

Notice is hereby given that the following has applied to the Licensing Office of Epping Forest District Council for the grant of a premises licence for the premises at 121 High Street, Westland, London, E11 2HL.

PHYLIS PATRICIA FAYNE deceased

Pursuant to the Trustee Act 1925, notice is hereby given that any person having a claim against or interest in the estate of the above named deceased should make known to the executor...

NORA LAWRENCE-BROWN (deceased)

Pursuant to the Trustee Act 1925 any person having a claim against or interest in the estate of the above named deceased should make known to the executor...

Legal Notices

Essex County Council Section 53 Wildlife and Countryside Act 1981 Definitive Map and Statement for the County of Essex

The Essex County Council Definitive Map Modification No. 578 (Footpath 127 Loughton, Epping Forest District) Act 2014

The above Order made on 5th March 2014, if confirmed as made, will modify the Definitive Map for the area by:- Adding a footpath running from Borders Lane, Loughton near Epping Forest College...

A copy of the Order and the Order map may be seen free of charge during normal office hours at Epping Forest District Council, Civic Offices, High Street, Epping, CM16 4BZ and at the Chelmsford Library, Market Road, where copies will be available on request at a charge.

Any representation or objection relating to the Order must be sent in writing to the Head of Essex Legal Services, Essex County Council, 2014 and it is requested that the grounds on which it is made are stated.

If no representations or objections are duly made to the Order or if any so made are withdrawn, the Essex County Council, instead of Order, if the Order is submitted to the Secretary of State for the Environment, Food and Rural Affairs, any representations or objections, which have been duly made and not withdrawn, will be sent with it.

Dated: 10th April 2014 P M Thomson, Director for Essex Legal Services, Essex Legal Services, New Bridge House, 60-66 New London Road, Chelmsford Essex CM2 0PD

CLICK fimo It's the business directory you want to be on. FREE Business listings from your local newspaper. Call: 0208 722 6414 or join online at: guardian-series.co.uk/click2find

Epping Forest District Council PUBLIC NOTICE OF APPLICATION FOR A GRANT OF A PREMISES LICENCE... Planning applications affecting a Conservation Area or setting of a listed building...

PHYLIS PATRICIA FAYNE deceased Pursuant to the Trustee Act 1925, notice is hereby given that any person having a claim against or interest in the estate of the above named deceased should make known to the executor...

NOTICE OF APPLICATION FOR THE GRANT OF A PREMISES LICENCE... Application has been made to the Licensing Office of Epping Forest District Council for the grant of a premises licence for the premises at 121 High Street, Westland, London, E11 2HL.

Ads 24/7 Online booking day or night www.guardian-series.co.uk/ads247



Licensing Department, Epping Police Station  
230 High Street, Epping, CM16 4AP  
Telephone 01279 625 405 Facsimile: 01279 625 440  
Website: [www.essex.police.uk](http://www.essex.police.uk) Email: [Peter.Jones@essex.pnn.police.uk](mailto:Peter.Jones@essex.pnn.police.uk)

Mrs Kim Tuckey  
Licensing Department  
Epping Forest District Council  
Civic Offices  
High Street  
Epping  
CM16 4BZ

7 April 2014

Dear Kim,

**LICENSING ACT 2003 – GRANT OF PREMISES LICENCE SECTION 17**  
**NEW PREMISE: Martins, Brook Parade, Chigwell**  
**DPS: Steve Mahoney**  
**APPLICANT: McColls Retail Group**

Further to the above application for the Grant of a Premises Licence received on 1 April 2014. I can now confirm that all my checks have been carried out and can confirm that Essex Police will not be making any representations or objections to this application in respect of the licensing objectives.

I trust the aforementioned will assist and look forward to receiving a copy of the Licence, if/when processed, in due course.

Yours sincerely,

Mr Peter Jones ABII  
Epping & Brentwood Licensing Officer  
West LPA

Cc. **Mr S Mahoney**  
**Martin McColl Ltd**  
**Martin McColl House**  
**Ashwells Road**  
**Pilgrims Hatch**  
**Brentwood**  
**Essex**  
**CM15 9ST**



Licensing Applications  
Quality Assurance & Safeguarding (inc IRO) Service  
Family Operations  
A Block 202, County Hall  
Chelmsford CM1 1YS  
Tel: 01245 436744 Email: LicenceApplications@essex.gov.uk



Licensing Officer  
Licensing Section  
Epping Forest District Council

Your ref: -  
Our ref: 04-2014/04  
Date: 08 April 2014

Dear Martins

**RE: Licensing Act 2003:**

The licensing application received on 1 April 2014 has been assessed and we can confirm we have no objections to this licence application.

Yours sincerely

**Paula Stacey**  
**Interim Service Manager, Safeguards,**  
**Quality Assurance & Safeguarding (inc IRO) Service**



EssexWorks.  
For a better quality of life

# Essex County Fire & Rescue Service

Mr David Johnson LL.B(Hons), BSc, MA, MSc, FCMJ  
Chief Fire Officer & Chief Executive



Sarah Kits  
Licensing Compliance Officer  
EFDC  
Civic Offices  
High Street  
Epping  
CM16 4BZ

WEST AREA COMMAND  
Harlow Service Delivery Point  
Fourth Avenue  
HARLOW  
CM20 1DU  
☎ 01279 420841  
✉ he.command@essex-fire.gov.uk

Date: 04 April 2014  
Our Ref: 72/100091480215  
Enquiries to: Steve Nicholl

Dear Madam,

**LICENSING ACT 2003**  
**THE REGULATORY REFORM (FIRE SAFETY) ORDER 2005**  
**Premises: Martins 3 Brook Parade Chigwell Essex IG7 6PE**

Receipt is acknowledged of the above consultation, which will be audited by the Essex Fire Authority (The Authority).

Should there be any significant concerns regarding the application you will be notified in due course.

Yours faithfully

Steve Nicholl  
Technical Fire Safety Officer

## Sarah Kits

---

**From:** Anthony Belgrave <chigwellparishcouncil.gov.uk>  
**Sent:** 24 April 2014 16:02  
**To:** Licensing  
**Subject:** Martins, 3 Brook Parade, Chigwell, IG7 6PE - Application for a new premises licence

Sarah Kits  
Licensing Compliance Officer  
Epping Forest District Council  
Neighbourhoods Directorate  
Civic Offices  
High Street  
Epping  
Essex  
CM16 4BZ

Dear Madam,

At a meeting held on Wednesday 23<sup>rd</sup> April 2014 the Chigwell Parish Council Planning Committee considered the notification regarding the application of a premises licence at **Martins, 3 Brook Parade, Chigwell, Essex, IG7 6PE**. After discussion it was moved by the Chairman and resolved that the committee would communicate several concerns to you arising from the aforementioned application. These are listed as follows;

- a) The current number of already licensed premises all within a disproportionately small area. Namely Mace Supermarket, Chigwell Food & Wine, Papillion Restaurant, and King William IV pubic house.
- b) The possibility of public nuisance and the risk of exacerbating an already existing problem of anti-social behaviour in the immediate vicinity of the village green, and near-by secluded car park.
- c) The Council has also been made aware of local resident's sizeable protestations to such a licence being granted.
- d) The significant number of school attendees that frequents the vicinity of Brook Parade and the surrounding area.

Yours sincerely,

Anthony Belgrave  
Administration Officer  
Chigwell Parish Council  
Hainault Road  
Chigwell  
IG7 6QZ  
Tel no:  
Fax no:

[chigwellparishcouncil.gov.uk](http://chigwellparishcouncil.gov.uk)

## Sarah Kits

---

**From:** Wynne, Daniel  
**Sent:** 04 April 2014 11:12  
**To:** Licensing  
**Subject:** Objection to Licence Application

Dear Sirs,

Applicant Name: McColls Retail Group

Address of Premises: Martins, 3 Brook Parade, Chigwell, Essex, IG7 6PE

My Name: Daniel Wynne

My Address: Dickens Rise, Chigwell, Essex,

Thank you for your letter dated 1<sup>st</sup> April 2014 regarding the application for a licence at the premises stated above.

As a neighbour I am writing to formally give my objections.

I understand there are 4 areas under which I can object namely:

- i) The prevention of crime and disorder
- ii) Public safety
- iii) The prevention of public nuisance; and
- iv) The protection of children from harm.

I would like to raise objections under points i), ii) and iii).

Brook Parade is a small parade of shops in Chigwell village which unfortunately attracts large numbers of youths (aged 13-19) at night especially during the summer months. They loiter outside the two establishments that already sell alcohol until a late hour.

Should the applicant be successful with its application, this will mean a third outlet within the space of 10 shops of each other that would be able to sell alcohol and attract the youths to congregate.

There is already an intimidating atmosphere at times which has resulted in the local police being called.

Another shop selling alcohol would in our opinion be a further threat to Public Safety and will create a public nuisance as the youths will continue to gather in greater numbers.

The more youths that are fuelled by alcohol (one can assume a price war between the three shops in order to attract more business will take place) could result in an increase to the levels of crime and lead to more public disorder.

The neighbours who need to purchase alcohol from a convenient local establishment already have two options within a few feet from each other. A third is not needed and if successful it is likely to result in the concerns I have mentioned above.

I urge you not grant this licence.

Yours

Daniel Wynne  
Dickens Rise  
Chigwell  
Essex

CLAREMONT PLACE MANAGEMENT COMPANY LIMITED

TEL:

e-mail

BROOK PARADE  
CHIGWELL  
ESSEX

4 April 2014

The Licensing Team  
Epping Forest District Council  
Civic Offices  
High Epping  
Essex CM16 4BZ                      and by e-mail to [licensing@eppingforestdc.gov.uk](mailto:licensing@eppingforestdc.gov.uk).

Dear Sirs

**Licensing Application by Martins  
3 Brook Parade, Chigwell, Essex, IG7 6PE**

Dear Sirs

I wish to oppose the application on behalf of myself and all residents of Claremont Place, whose permission I have for that purpose.

There are already 2 shops on Brook Parade, within a few yards of Martins, selling alcohol from morning until late evening. Both shops are regularly used by young people and by school children.

Having another source of alcohol within such close proximity would simply further encourage public drinking in this residential community, all day and night.

My grounds for opposing are therefore:

**To prevent public nuisance  
To prevent crime and disorder  
To protect children from harm, and  
In the interest of public safety.**

Yours faithfully

Carrol Nathanson  
Director/Secretary  
and Director of Claremont Freehold Chigwell Limited

**Sarah Kits**

---

**From:**  
**Sent:** 11 April 2014 20:16  
**To:** Sarah Kits  
**Subject:** Re: Licence application for McColls Retial Group

OK

Mr L M Berman  
Dickens Rise  
Chigwell  
Essex

Thank you

-----Original Message-----

From: Sarah Kits <skits@  
To: 'Lawrence Berman' <  
Sent: Fri, 11 Apr 2014 14:09  
Subject: RE: Licence application for McColls Retial Group

Dear Lawrence,

Thank you very much for your e-mail.

In order for me to be able to accept your representation could you please include a contact address; we are unable to accept anonymous objections.

Kind regards

Sarah Kits  
Licensing Compliance Officer

☎ 01992 564403

✉ [skits@eppingforestdc.gov.uk](mailto:skits@eppingforestdc.gov.uk)  
[www.eppingforestdc.gov.uk](http://www.eppingforestdc.gov.uk)

---

**From:** Lawrence Berman |  
**Sent:** 09 April 2014 10:29  
**To:** Licensing  
**Subject:** Licence application for McColls Retial Group

Regarding the the above for Martins, 3 Brook Parade, Chigwell, Essex, IG7 6PE

**I am making representation against the application, on the following grounds:**

- **'The prevention of public nuisance'** – numbers of teenagers and young people gather at Brook Parade and on the green opposite – having additional provision of alcohol including unsociable hours from 0600hrs to 2300hrs will encourage alcohol fuelled congregation leading unsociable behaviour.
- **'Public Safety'** – with larger numbers of youths congregating and consuming alcohol in a public area at early and late hours, Public Safety is at risk.

- As there is a child's playground opposite the site any encouragement of alcohol drinking by numbers of youth, that this permission will provide, is an obvious threat to **'the protection of children from harm'**
- All of the above threats would be caused by granting this license and therefore would be at odds with **'the prevention of crime and disorder'**.

I hope these serious issues are considered and is so it would be irresponsible to grant this permission.

Lawrence Berman

#### DISCLAIMER

This email is for the use of the intended recipients only. Any opinion or advice it contains is that of the sender and does not bind the authority in any way. If you have received it in error, please notify the sender immediately and then delete the message. If you are not the intended recipient you must not use, disclose, copy or distribute this email.

We have taken precautions to minimise the risk of transmitting software viruses, but we advise that you carry out your own virus checks on an attachment to this message. We cannot accept liability for any loss or damage caused by software viruses.

Internet email is not a secure communication medium, and we advise that you observe this lack of security when emailing us.

Epping Forest District Council

[Postmaster@Eppingforestdc.gov.uk](mailto:Postmaster@Eppingforestdc.gov.uk)

Brook Parade  
High Road  
Chigwell  
Essex

**Licensing Department**  
Epping Forest District Council  
Civic Offices  
High Street  
Epping  
CM16 4BZ

**Tel:**  
**Mob:**

04/04/2014

Dear Sir/Madam

I wish to object to the alcohol licence application by **MARTIN MCCOLL, 3 Brook Parade, Chigwell, Essex, IG7 6PE** which is currently is a Post Office and Newsagent.

likely to be directly affected by the licence than most other people.

I object to the application on the following grounds:

**Objection 1:**

Grounds for objection:

The grant of the alcohol licence would result in the over provision of licensed premises in the locality. There is already two other off license shops open from 07 Am to 11PM, a restaurant with alcohol licence at the Parade, the King Williams Pub nearby and about half a mile away there is another off license shop. The addition of another outlet selling alcohol in this location is inappropriate during daylight hours and after dark adds to concerns about breaches of the peace increasing in and around the park opposite the premises.

**Objection 2:**

People who lives at the parade already experiences **public disorder and nuisance**, including being asked by under-age youths to purchase alcohol for them. This is very intimidating for them and makes them frightened to go out in the evenings.



The granting of this application would provide a further source of alcohol within an area already so heavily populated with licensed premises. It would further attract groups of youths into the local area who would engage in alcohol related disorder. And also Noise, public nuisance, anti-social behaviour, low-level nuisance (non reportable crime inc. shouting, swearing, urination in public, littering) will be increased.

I have reported to the police many times about children and young people hanging around outside the premises and the area hoping to obtain alcohol. The groups of young people usually congregate outside the front of the premises, shouting and creating loud noise. The members of the public have to walk on the road feel threatened when passing the premises due to their behavior. They also caused annoyance to neighbors above the premises.

The basis for this opposition is that granting an alcohol licence for the **MARTIN MCCOLL, 3 Brook Parade** premises will not promote the licensing objectives, particularly the prevention of crime, disorder and antisocial behaviour.

Residents in this area already suffer noise nuisance and antisocial behaviour, I cannot see any benefit or necessity to our community by approving this application!

In view of the above, I would urge the Licensing Authority to refuse the application.

Yours faithfully

Kamran Ali

Brook Parade  
Chigwell  
Essex

Licensing Department  
Epping Forest District Council  
Civic Offices  
High Street  
Epping  
CM16 4BZ

08/04/2014

Dear Sir/Madam

I would like to object to the alcohol licence application by Martin Mccoll, 3 Brook Parade, IG7 6PE.

The grounds of my objections are as follows:

We are already suffering antisocial behavior, noise and nuisance, granting the licence will draw more young people from wider area, which will cause annoyance to members of the public and neighbours around the premises.

By Increasing access and availability of alcohol through increasing numbers of premises and/or opening hours the consumption will be increased, which in turn potentially leads to increase public harm. However, Even small reductions in the availability of alcohol can contribute to health gain and reduce violence and harm to the public generally, as well as to the drinker themselves.

Based on the points I have stated above it is necessary for the purposes of the crime prevention objective that the application be refused.

Yours faithfully

E Evangelou

Mr C & Mrs D Myers  
Dickens Rise  
Chigwell  
Essex

Epping Forest District Council  
Licencing Unit Civic Offices  
High Street  
Epping  
CM16 4BZ

8 April 2014

Dear Sir,

**McColls Retail Group**  
**Martins, 3 Brook Parade, Chigwell, IG7 6PE**

Thank you for your letter dated 1<sup>st</sup> April concerning the above named application for a licence to sell alcohol.

We would like to register our objection to this.

There are already two outlets on what is a small parade of shops that sell alcohol and a third is not needed or wanted.

There is no public need for a further shop to stay open late into the evening selling alcohol and we can see no benefit of this to the general public.

It will only serve to have more youths gathering in the area and making a nuisance of themselves.

Please register our objection to this application.

Yours faithfully

Clive and Deborah Myers.

**From:** B. Kunhya  
**Sent:** 12 April 2014 19:32  
**To:** Licensing  
**Subject:** Martins - Sales of Alcohol

Dear Sir/Madam,

I am writing to make a representation in respect of the above application, Martins - Alcohol sales.

1. There are already several outlets selling alcohol in the parade and a big pub nearby.
2. A large number of children and youngsters in gangs already smoke and drink behind the HSBC Bank and along the path behind the bank leading to Dickens Rise. Gangs urinate all the time behind the bank, along the path and nearby dark spaces. They are using the dark areas as public toilets.
3. Gangs block the path and always threaten elderly people using this public path. More alcohol will definitely contribute to crime and disorder. There is already enough alcohol and smoking by youngsters as it is in the dark areas behind the parade.
4. Children roam around the streets behind the parade after school and holidays. Threatening behaviour are always used against local residents. They knock on doors supposedly looking for their friends. They throw bottles at residents. They are a public nuisance and with more alcohol this may lead one day to a major incident/crime. Well known brands of wine are being sold at £4 a bottle along the parade, cheaper than Tesco/Sainsbury.
5. More alcohol in the area will not help children and youngsters, and also it's the residents who have to put up with the nuisances and disorders.

Thanks you

Mr B Kunhya · Dickens Rise

**DISCLAIMER**

This email is for the use of the intended recipients only. Any opinion or advice it contains is that of the sender and does not bind the authority in any way. If you have received it in error, please notify the sender immediately and then delete the message. If you are not the intended recipient you must not use, disclose, copy or distribute this email. We have taken precautions to minimise the risk of transmitting

## Sarah Kits

---

**From:** William Yeung  
**Sent:** 28 April 2014 13:22  
**To:** Licensing  
**Subject:** Opposition to granting licensing to Martins, Chigwell

Dear Sir/Madam,

I wish to oppose the granting of a licence to McColls Retail Group at Martins, 3 Brook Parade, Chigwell on the following grounds:

1. Prevention of crime and disorder,
2. the prevention of public nuisance and
3. protection of children from harm.

There are already two other licensees in Brook Parade and the only reason for having another is to provide competition and more opportunity to obtain alcohol. More competition would drive the apparent price of alcohol thus encouraging irresponsible drinking.

Residents in the area including ourselves usually buy our wines and spirits in the supermarkets and the only reason we would buy from the Brook Parade is for convenience i.e. when we need some wine in a hurry or out of normal supermarket hours. We do not need more than two outlets for this purpose.

In good weather especially in the summer, children congregate in the local park/playground opposite Martins. It is not impossible for one of them to purchase alcohol from one of the off licences in Brook Parade. Having another licensee would increase the chance of children or other irresponsible people obtaining alcoholic drinks and consuming them in the park.

I would appreciate if you would acknowledge this email.

Sincerely

William and Christina Yeung  
Dolphin Court  
High Road  
Chigwell

The Licensing Team  
Epping Forest District Council,  
Civic Offices  
High Street  
Epping  
CM16 4BZ

Date 04/04/2014

We, the residents of Chigwell, object to the granting of an alcohol licence to **MARTIN MCCOLL**,  
**3 Brook Parade, Chigwell, Essex, IG7 6PE.**

We object to the application for alcoholic license on the grounds of:

1. **Granting the licence would result in overprovision of licensed premises in the locality (i.e., too many premises of a particular type in the area).**
2. **The use of the premises and grant of the regular extension of permitted hours for the sale of alcohol will cause undue public nuisance, a threat to public order and safety.**
3. **The grant of the application would further attract groups of youths into the local area who would engage in alcohol related disorder.**
4. **Granting the licence would cause undue offence, annoyance, disturbance or inconvenience to people who reside and work in the vicinity.**

The contact person for this petition is: **Mr Kamaran Ali**  
Brook Parade  
Chigwell  
Essex

Objectors – Please print clearly

	Name	Address	Signature
1	G. LANCASTER	CHESHAM WAY CHISWELL ESSEX	(
2	H. CHANDLER	LYNDWOOD ROAD PHILIPSBURY	)
3	J DOBINS	Fontaine Avenue	
4	A SANDS	TUDOR CLOSE	
5	T. OFFORD	Hicot 2!	
6	P DAVIS	DICKENS ROAD Chiswell	1
7	D Welford	Love Lane Chiswell	
8	J. GWALTER	MEADOW WAY CHISWELL	

9	R BREWERT	COOLGARDIE AVUNE CHINWELL
10	M. O'SHAUGHNESSY	COOLGARDIE AV. CHIGWELL.
11	TAMES	Brook way Chigwell
12	S DAVIS	BROOK RISE CHIGWELL
13	CAWARD	DICKENS RISE Chigwell
14	BATSMAN	Barnaby way Chigwell
15	Baker	Dickens Rise Chigwell
16	S. JAY.	BROOK way,
17	ASHLEY WARDER	CHIGWELL PARK



18	K. Bett	LEAMING AVE	
19	A. ALLEN	STATION ROAD	
20	D. Suggman	Dickens Rise	
21	4 Burgess	Forest Terrace	
22	L. Chapman	Wentworth Rd	
23	(	Forest Terrace High Rd	
24	J. BLINN	HAINAULT RD CHICHEWELL ESSEX	

Date 07/04/2014

**The Licensing Team  
Epping Forest District Council,  
Civic Offices  
High Street  
Epping  
CM16 4BZ**

**We, the residents and businesses of Brook Parade, IG7 6PE, object to the granting of an alcohol licence to Martin Mccoll, 3 Brook Parade, Chigwell, Essex, IG7 6PE.**

**We object to the application for alcoholic license on the grounds of:**

- 1. The use of the premises and grant of the regular extension of permitted hours for the sale of alcohol will cause undue public nuisance, a threat to public order and safety.**
- 2. The grant of the application would further attract groups of youths into the local area who would engage in alcohol related disorder.**
- 3. Granting the licence would cause undue offence, annoyance, disturbance or inconvenience to people who reside and work in the vicinity.**
- 4. Granting the licence would result in overprovision of licensed premises in the locality (i.e., too many premises of a particular type in the area).**

**The contact person for this petition is: Mr Kamaran Ali  
Brook Parade  
Chigwell  
Essex**

Objectors – Please print clearly

	Name	Address	Signature
1	R Chick	BROOK PARADE	
2	S. Rupani	Brook Parade	
3	Mukesh	Chigwell Rise	
4	I. Foster	New Banks Way Chigwell	
5	C FOSTER	BROOK PARADE	
6	V. KENT	Brook Parade Chigwell	
7	D. Read	SPACE Brook Parade	

8	T. Ainder	Forest Terrace Chigwell
9	E. EVANGELOU	BROOK PARADE Chigwell
10	D. Wood	Barnaby Way Chigwell
11	Jan Cavell	BROOK parade CHIGWELL
12	Karen Cowell	Brook <del>par</del> Mews.
13	Ivohodymyr Stetsiuk	Brook Mews
14	CARLOS FERNANDES	BROOK PARADE
15	SÉRGIO FERNANDES	BROOK PARADE
16	Katie North	BROOK Parade
17	DONNA ASTON	DICKENS KISE

18	MRS. J. R. ESTER	BROOK HILLS Hill Road CHEWELL ES
19	Chigwe	BROOK PARADE Chigwe
20	VICTOR CIBAS	BROOK HILLS
21	Brook Buds	Brook parade.
22	FOLLOWING	Brook Hills
23	DR	BROOK WAIN
24	WILSON	BROOK PARADE



Epping Forest District Council

Civic Offices  
High Street  
Epping CM16 4BZ

Centre X: 543716.856  
Centre Y: 193141.952  
Width : 225.000  
Angle : .000

Scale : 1:1250

Date : 29 Apr 2014

Time : 06:12:03 PM

Contains Ordnance Survey & Royal Mail Data © Crown Copyright & Database Right 2012, EFDC License No: 100018534 2012 © Royal Mail Copyright & Database Right 2012, © Environment Agency, © Copyright Geo Perspectives, © Natural England 2012, Reproduced with the permission of Natural England

